



**WOODFORD  
MODEL 19**  
ANTI-BURST FAUCET

**WILL  
NOT  
BURST.  
GUARANTEED.\***



Look for the  
oval handle!



**5-YEAR  
WARRANTY**

*\* If installed correctly*

WOODFORD



WOODFORD MANUFACTURING  
COMPANY

Excellence. *Always.*

800.621.6032

[www.woodfordmfg.com](http://www.woodfordmfg.com)

**This unit offers anti-siphon and non-rupture protection.**

The Freezeless Model 19 is intended for irrigation purposes and designed for year-round residential regardless of outside temperature. This product contains an integral backflow protection device which protects up to 125 psi of backpressure and therefore does not require an add-on vacuum breaker. This ASSE 1019 device is intended for irrigation use and outdoor watering and shall not be subjected to more than (12) hours of continuous water pressure.

**SPECIFICATIONS:**

- Manufactured under one or more of the following patents. Patent Information see: <https://www.woodfordmfg.com/patents>
- ASSE 1019 - Type C Listed
- CSA, cUPC Approved
- Not intended for continuous use



**FEATURES:**

- *Patented resetting pressure relief valve prevents the faucet tube from bursting in freezing conditions even if a hose is unintentionally left on.*

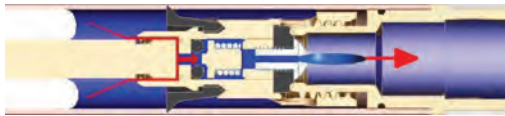

- 3/4" male hose thread nozzle
- Stainless steel seat - eliminates wire draw
- EPDM packing to prevent leaking
- Full circle operating threads on valve body and retainer
- No-lead solder
- Standard "O" size seat washer
- Oval, powder-coated, die cast aluminum handle
- Optional Tee Key available (extra charge)
- Adjustable polycarbonate wall flange
- **MAX PRESSURE** - 125 p.s.i.
- **MAX TEMPERATURE** - 120° F

**INSTALLATION REQUIREMENTS:**

- The faucet length used is to be comparable to what would be used with standard freezeless faucets.
- The inlet connection must be located in a heated area.
- The gap between the house and faucet must be sealed to prevent air leaks.
- The faucet must be installed with a slight downward pitch toward the nozzle.
- Adequate insulation is required around the faucet, wall board and sill plate.

**For Installation / Troubleshooting Instructions go to [www.woodfordmfg.com](http://www.woodfordmfg.com) or call 1-800-621-6032**

# Freezeless Anti-Siphon Wall Faucet Model 19

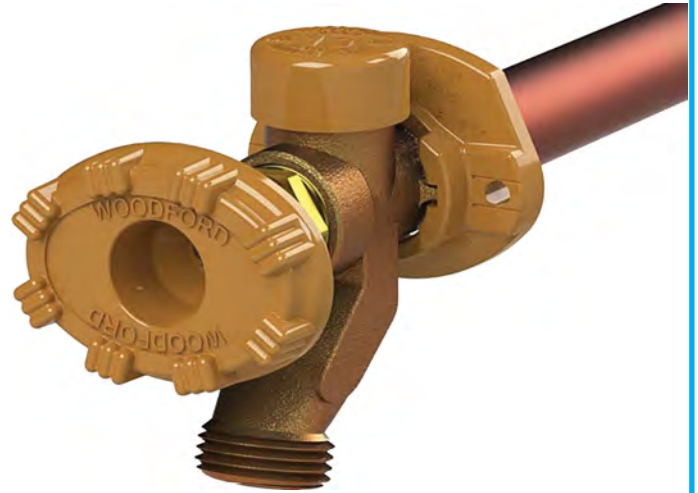

**Inlet Descriptions**

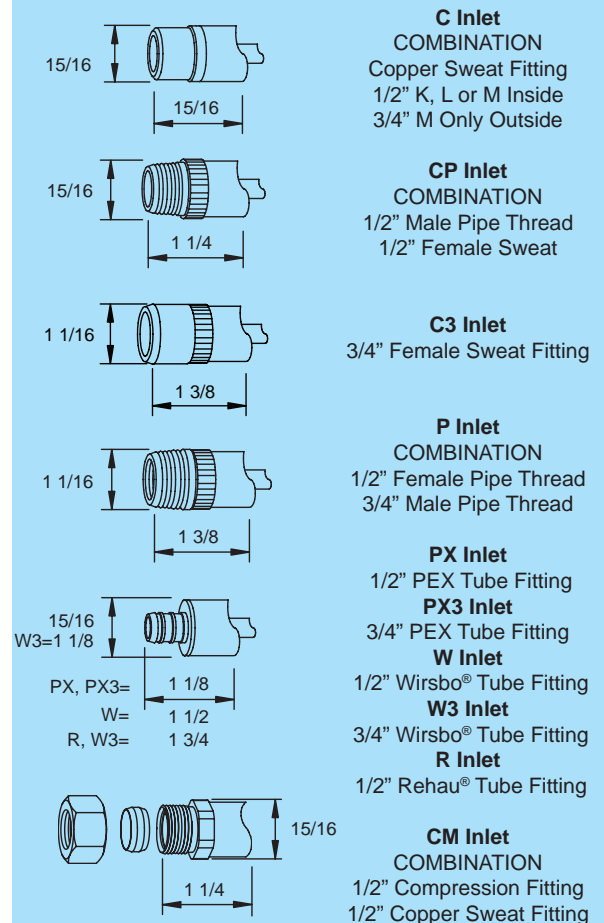

**When ordering, specify model , inlet and wall thickness.**

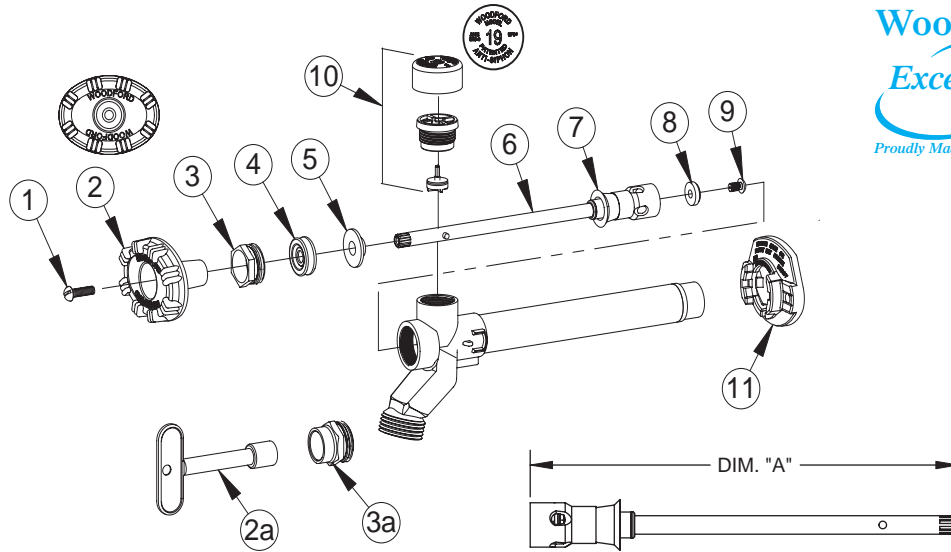

**MODEL 19 PARTS LIST**

ITEM	PART#	DESCRIPTION
1	30002	Handle Screw
2	30559	Oval Wheel Handle - Powder Coated Die Cast Aluminum
2a	50012	Tee Key (Optional)
3	30059	Packing Nut
3a	30512	Packing Nut w/deep stem guard (Optional)
4	30560	EPDM Packing
5	30421	Packing Support Washer
6	RK-PRV	Valve Stem Assembly (See chart at right)
7	30459	Check Valve
8	30008	Valve Seat Rubber
9	30804	Retainer Screw
10	RK-19VB	Vacuum Breaker Float Kit - Model 19
11	30098	Adjustable Flange
	RK-19	Repair Kit (Includes items 1-5, 7-10)

**RK-PRV and Replacement Rod #**

Wall Thickness	RK-PRV*	Rod Only Part #**	Overall Length Dim "A"
4	RK-PRV-4	35092	5 7/8"
6	RK-PRV-6	35093	7 7/8"
8	RK-PRV-8	35094	9 7/8"
10	RK-PRV-10	35095	11 7/8"
12	RK-PRV-12	35096	13 7/8"
14	RK-PRV-14	35097	15 7/8"
16	RK-PRV-16	35098	17 7/8"
18	RK-PRV-18	35099	19 7/8"
20	RK-PRV-20	35100	21 7/8"
22	RK-PRV-22	35101	23 7/8"
24	RK-PRV-24	35102	25 7/8"

\*RK-PRV Includes Items 1 - 4, 6 - 9

\*\*Rod Includes Items 6 - 9

**Rough-In Dimensions**

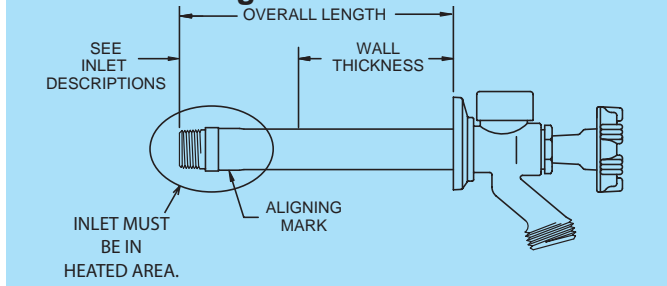

Wall Thickness (inches)	4	6	8	10	12	14	16	18	20	22	24
	1.2	1.3	1.4	1.5	1.6	1.7	1.8	1.9	2.0	2.1	2.2

Shipping Wt. Ea. (lbs)

\*Overall Length Dimension: Add wall thickness and inlet option length shown in chart above.

**LIMITED WARRANTY**

All Model 19 Wall faucets are sold with a limited warranty for five (5) years against defects in material and workmanship. We will replace or issue credit (at our option) for defective goods that are returned for inspection and found to be defective within five (5) years of purchase from Woodford. In addition, Woodford will pay up to \$5,000.00 toward the cost to repair damages incurred as a result of a defective Model 19 Wall Faucet that was properly installed. This limited warranty does not cover defects caused by: modification, alteration or repair of the product by anyone other than Woodford; physical abuse to, or misuse of, the product or operation thereof in a manner contrary to accompanying instructions.

For more information contact...

**WOODFORD MANUFACTURING COMPANY**

2121 Waynoka Road, Colorado Springs, Colorado 80915 • Phone: (800) 621-6032 • Fax: (800) 765-4115

To view our complete product line visit: [www.woodfordmfg.com](http://www.woodfordmfg.com) or email: [sales@woodfordmfg.com](mailto:sales@woodfordmfg.com)

# INSTALLATION INSTRUCTIONS



For more information contact...

## WOODFORD MANUFACTURING COMPANY

2121 Waynoka Road, Colorado Springs, Colorado 80915 • Phone: (800) 621-6032 • Fax: (800) 765-4115

To view our complete product line visit: [www.woodfordmfg.com](http://www.woodfordmfg.com) or email: [sales@woodfordmfg.com](mailto:sales@woodfordmfg.com)

A Division of WCM Industries, Inc.

Rev 12/19 Form No. II19.103

## Model 16 & 19 Anti-Burst Freezeless Wall Faucet



Model 16  
No anti-siphon protection.

Model 19  
Anti-siphon protected.

FIGURE 1

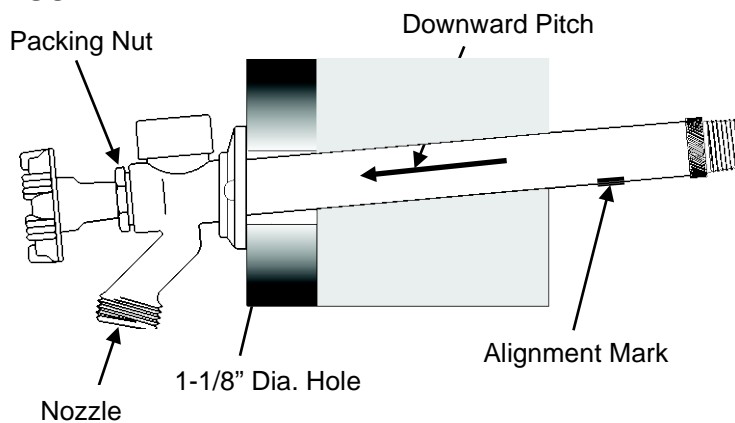
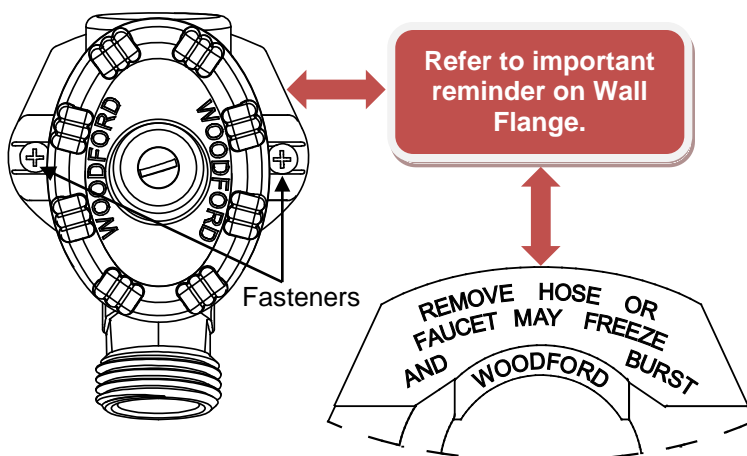

FIGURE 2



Wall faucets must be properly installed and operated to insure drainage. Improperly installed or operated wall faucets may freeze and burst in freezing weather.

### INSTALLATION INSTRUCTIONS:

1. Before installation, flush supply line to remove any debris.
2. Drill a 1-1/8" diameter hole through the wall in the desired location and insert the faucet from the outside. **FIGURE 1**
3. Install with nozzle pointing down. **FIGURE 1**
4. From inside the building, the alignment mark on the tube can be used to correctly align the faucet when the mark is pointed down. **FIGURE 1**
5. The tube must have a slight downward pitch for proper drainage. **FIGURE 1**
6. For solder connection, open faucet to full open position before soldering. Excessive heat can damage valve seat rubber or stainless steel seat and factory solder joint.
7. Secure faucet to the wall using appropriate fasteners installed through the holes in the flange. Adjustable flange matches slope of siding. **FIGURE 2**

**NOTE:** The packing nut, located behind the handle, has been factory adjusted. If leakage should occur after installation or use, the packing nut can be tightened to stop the leak. **FIGURE 1**

This ASSE 1019 device is intended for irrigation use and outdoor watering and shall not be subjected to more than (12) hours of continuous water pressure.

# TROUBLESHOOTING & MAINTENANCE



For more information contact...

## WOODFORD MANUFACTURING COMPANY

2121 Waynoka Road, Colorado Springs, Colorado 80915 • Phone: (800) 621-6032 • Fax: (800) 765-4115

To view our complete product line visit: [www.woodfordmfg.com](http://www.woodfordmfg.com) or email: [sales@woodfordmfg.com](mailto:sales@woodfordmfg.com)

A Division of WCM Industries, Inc.

Rev 07/12 Form No. TM19.102

## Model 19 Freezeless Wall Faucet

### How A Frost-Proof Faucet Works

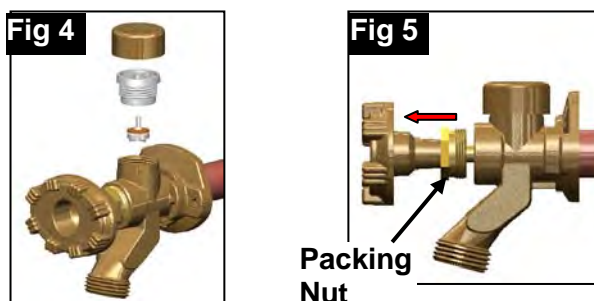
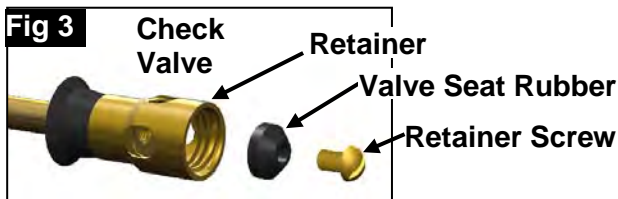
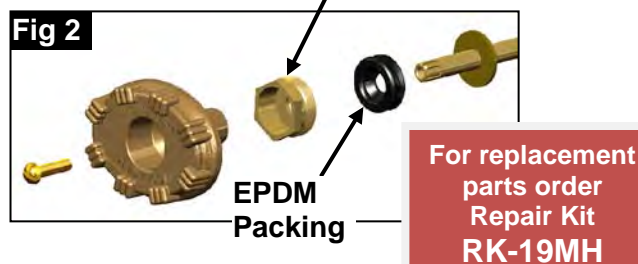
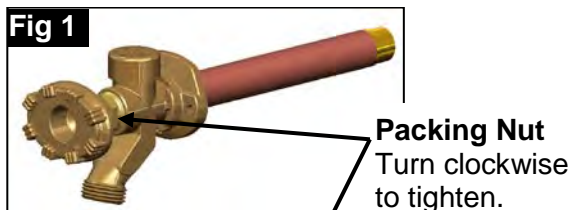

- **Packing leak: Faucet leaks from around the operating stem when it is on**

The hex **Packing Nut** (30059) will occasionally need to be tightened to stop a packing leak. (**Fig 1**) Without removing any parts, tighten the packing nut behind the handle until snug and the leak stops. Persistent leaks will require a new **EPDM Packing** (30560) (**Fig 2**).

- **Faucet will not shut off: Water runs or drips out nozzle when the faucet is off**

The **Valve Seat Rubber** (30008) is worn or damaged and needs to be replaced or the **Retainer Screw** (30804) is loose. (**Fig 3**) Follow the instructions below on how to remove the **Operating Rod**. (**Fig 4 & 5**) If this does not fix the leak, the faucet may have a damaged seat and the faucet will need to be replaced.

- **Faucet leaks from the vacuum breaker, on top of the faucet, when the faucet is on.**

Vacuum breaker is fouled or damaged. (**Fig 4**) Pry off plastic cap and use pliers to remove the vacuum breaker body. Check for fouling or replace with vacuum breaker float kit (RK-19VB).

- **Valve Stem Assembly - Operating Rod Removal**

To remove the operating rod from the faucet, shut off the water supply, loosen the handle and back out the **Packing Nut** (**Fig 5**). Use the handle to turn the rod counterclockwise until the rod becomes disengaged from the valve seat. Use a small screwdriver to pry the packing loose. Pull the rod assembly out of the faucet. (**Fig 6**) The rod may have a check valve that will add resistance to removal. Use a swift pull to disengage it.

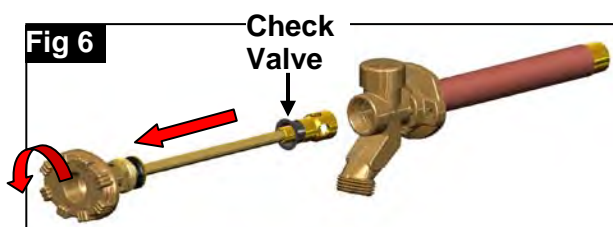

## FREEZELESS: (Tube won't freeze when hose is detached)

### MODEL 14

- No Anti-Siphon Protection
- Round, powder coated, die-cast aluminum handle

Packed 10 Per Master Carton

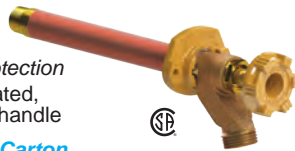

### Best Selling Residential Wall Faucet

### MODEL 17

- Anti-Siphon Protected
- ASSE-1019-C Listed
- Round, powder coated, die cast aluminum handle



MODEL*	WALL THICKNESS										
	4"	6"	8"	10"	12"	14"	16"	18"	20"	22"	24"
14C, 14CP, 14C1, 14PX, 14W	45.85	48.90	51.95	55.00	58.05	61.10	64.15	67.20	70.25	73.30	76.35
14P, 14C3, 14PX3	48.05	51.10	54.15	57.20	60.25	63.30	66.35	69.40	72.45	75.50	78.55
14CM, 14W3	50.10	53.15	56.20	59.25	62.30	65.35	68.40	71.45	74.50	77.55	80.60
17C, 17CP, 17PX, 17W	53.40	56.45	59.50	62.55	65.60	68.65	71.70	74.75	77.80	80.85	83.90
17P, 17C3, 17PX3	55.55	58.60	61.65	64.70	67.75	70.80	73.85	76.90	79.95	83.00	86.05
17R	56.70	59.75	62.80	65.85	68.90	71.95	75.00	78.05	81.10	84.15	87.20
17CM, 17W3	57.85	60.90	63.95	67.00	70.05	73.10	76.15	79.20	82.25	85.30	88.35

\*SUFFIX BP-Bulk pack cartons of 24 units are available at \$0.80 per unit less than published price on 4", 6", 8" 10" & 12" lengths ONLY.  
Plastic Handle (Suffix PH). Tee Key (Suffix TK) - Add 1.25 list each.

## ANTI-BURST: (Tube won't rupture even if hose is attached)

### Patented - PRV Pressure Relief Valve - Standard on models 16, 19, 22, V22 & C22

The patented, resetting PRV prevents the faucet tube from bursting in freezing conditions even if a hose is unintentionally left on.

The PRV protects up to 125 psi of backpressure and therefore does not require an add-on vacuum breaker.

Upgrade the Model 14 & 17 with RK-PRV Rod Assembly

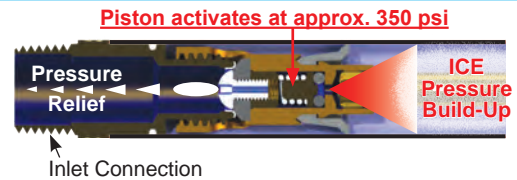

## PATENTED ANTI-BURST PRV

- See details above.
- ASSE-1019-C Listed (Model 19)
- Oval, powder coated, die cast aluminum handle



MODEL 16



MODEL 19  
With Anti-Siphon Protection

Packed 10 Per Master Carton

MODEL*	WALL THICKNESS										
	4"	6"	8"	10"	12"	14"	16"	18"	20"	22"	24"
16C, 16CP, 16PX, 16W	58.05	61.10	64.15	67.20	70.25	73.30	76.35	79.40	82.45	85.50	88.55
16P, 16C3, 16PX3	60.30	63.35	66.40	69.45	72.50	75.55	78.60	81.65	84.70	87.75	90.80
16CM, 16W3	62.30	65.35	68.40	71.45	74.50	77.55	80.60	83.65	86.70	89.75	92.80
19C, 19CP, 19PX, 19W	65.60	68.65	71.70	74.75	77.80	80.85	83.90	86.95	90.00	93.05	96.10
19P, 19C3, 19PX3	67.80	70.85	73.90	76.95	80.00	83.05	86.10	89.15	92.20	95.25	98.30
19R	68.70	71.75	74.80	77.85	80.90	83.95	87.00	90.05	93.10	96.15	99.20
19CM, 19W3	70.10	73.15	76.20	79.25	82.30	85.35	88.40	91.45	94.50	97.55	100.60

\*SUFFIX BP-Bulk pack cartons of 24 units are available at \$0.80 list per unit less than published price on 4", 6", 8" 10" & 12" lengths ONLY.  
Plastic Handle (Suffix PH). Tee Key (Suffix TK) - Add 1.25 list each.

- Hot and Cold connections
- Patented anti-burst PRV Pressure Relief Valve See details above.
- ASSE-1019-C Listed
- IAPMO/UPC® Listed
- Built-in anti siphon vacuum breaker
- One-piece head casting with integral hose connection
- Oval, powder coated, die cast aluminum handles



MODEL 22

MODEL V22

Optional DMP Drywall Mounting Plate. See Page 4 For Details.

Packed 4 Per Master Carton

MODEL 22 or V22	WALL THICKNESS										
	4"	6"	8"	10"	12"	14"	16"	18"	20"	22"	24"
C, CP, PX, W	156.30	162.30	168.30	174.30	180.30	186.30	192.30	198.30	204.30	210.30	216.30
P, C3, PX3	159.45	165.45	171.45	177.45	183.45	189.45	195.45	201.45	207.45	213.45	219.45
W3	164.10	170.10	176.10	182.10	188.10	194.10	200.10	206.10	212.10	218.10	224.10

Tee Key (Suffix TK) - Add 1.25 list each.